

Notes

Adams

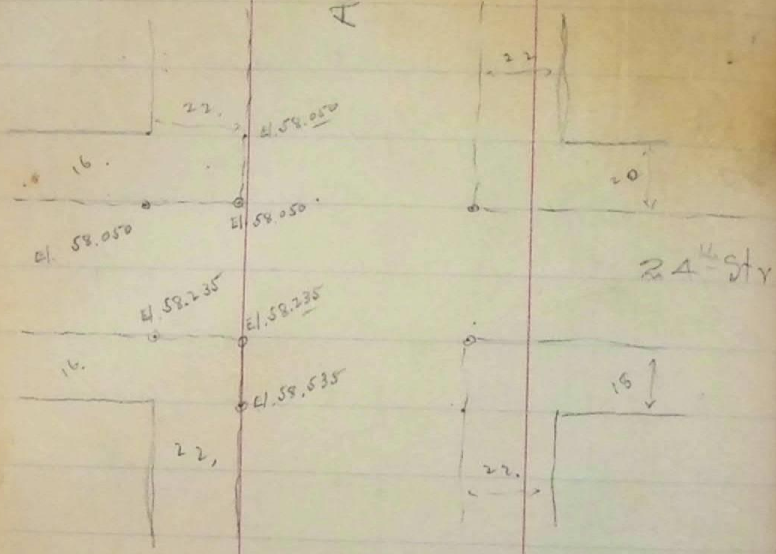

B.M. 4358.976 on City street, east side of Adams, as found by mean observations.

B.M. 4362.803 ✓ on N. end (front to building) of bottom steps of Catholic Church entrance marked by red lines. Elevation 4362.803 ± 0.005

B.M. 4375.354 ✓ on top of chimney part (Iron) 40 ft. N. E. cor. July 4 24 60 ft. by today's reading May 12 23 - mean

B.M. 4372.953 mean on City street, east side of Jefferson

Station Washington & Adams.

4368.050 ✓	Near	57.38	✓
	Center	57.72	✓
		57.96	"
		58.15	"
		58.30	"
		58.40	"
		58.47	"

Sta 107 + 27.5

58.47	✓
58.47	✓
58.47	✓
58.47	✓
57.87	✓
57.56	✓
4358.235	✓

19

4359.000

107 + 40.98

4359.000